

SOFTWOOD CAPS
 [AVAILABLE UPON REQUEST]
 SUITABLE FOR HIGH HUMUDITY ENVIRONMENTS

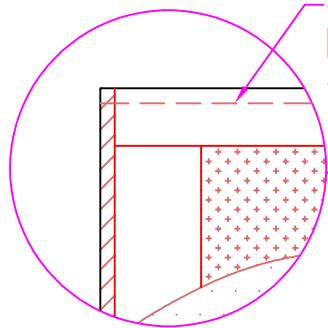

RAILS:
 76mm [3"] SCL TOP & BOTTOM RAILS

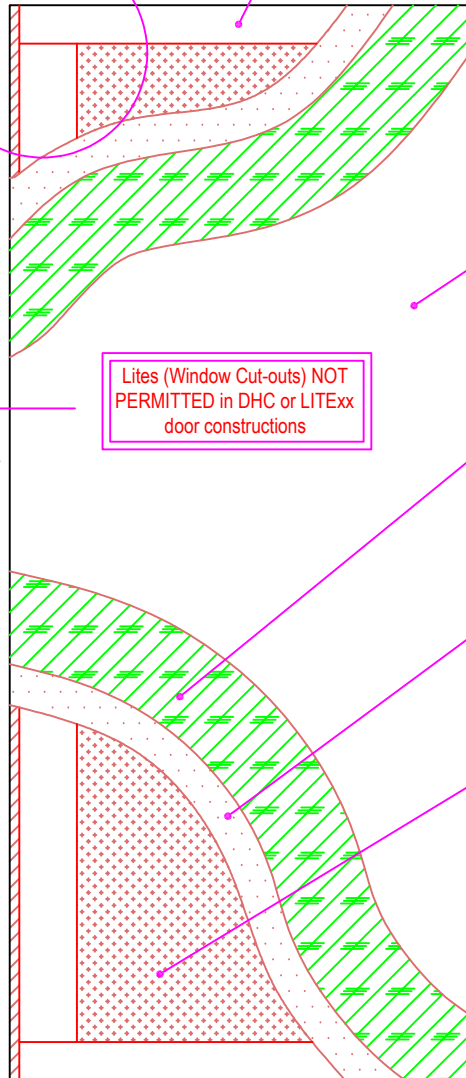

DOOR FACE:
 WOOD VENEER SPECIES OR
 PLASTIC LAMINATE [GP THICKNESS] OR
 ALTERNATE DOOR FINISH [as requested]

Lites (Window Cut-outs) NOT
 PERMITTED in DHC or LITExx
 door constructions

CROSSBAND:
 1.6mm [1/16"] COMPOSITE HDF
 **3mm [1/8"] COMPOSITE HDF
 for door widths > 48"

BALANCE SHEET:
 MATERIAL TO MATCH
 DOOR FACE MATERIAL THICKNESS

CORE:
 75 Kpa EXPANDED POLYSTYRENE (EPA)
 STYROFOAM CORE

NET DOOR HEIGHT

NET DOOR WIDTH

AVAILABLE DOOR SIZES:
 Most Veneers (restricted by species) 60"x96" or 48"x120"
 PL (P.Lam)(restricted by manufacturer) 60"x144"
 Standard Thickness - 1-3/8" or 1-3/4"

DOOR EDGES:
 19mm [3/4"] min. SOLID WOOD
 [SPECIES TO MATCH FACE]

STILES:
 114mm [4-1/2"] SCL

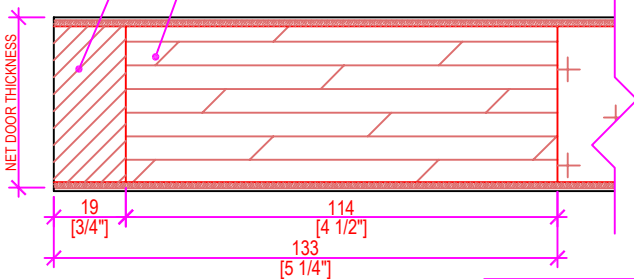

A-A DOOR EDGE DOOR SECTION
 SCALE: 6" = 1'-0"

STANDARD EDGE DETAIL
 #2 (AWMAC Type 'A')

 <small>Manufacturers of Fine Quality Millwork Doors & Paneling</small> 1150 Sanford Street Ph: (204) 786-1411 Fax: (204) 786-2634 Winnipeg, MB R3E 2Z9 www.dormonddoors.com	Date: MAR 10, 2021
	Revision:
Drawing: LITE20-7 FOAM CORE	
Drawn By: A.D.	Sheet: 1 of 1