

**SOFTWOOD CAPS**  
 [AVAILABLE UPON REQUEST]  
 SUITABLE FOR HIGH HUMUDITY ENVIRONMENTS

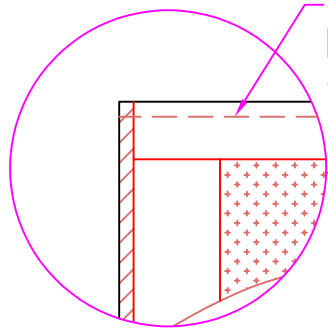

**RAILS:**  
 76mm [3"] SCL TOP & BOTTOM RAILS

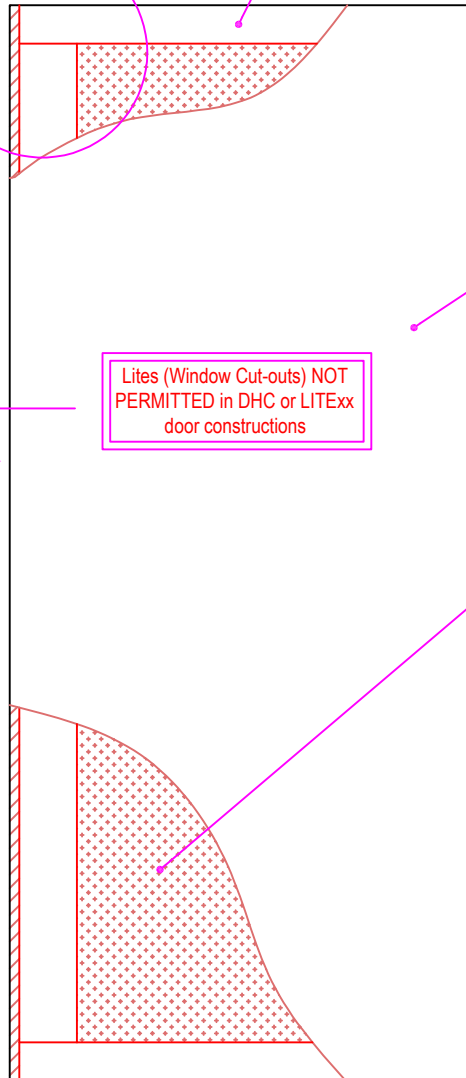

**DOOR FACE:**  
 3mm [1/8"] **HARDBOARD**

Lites (Window Cut-outs) NOT  
 PERMITTED in DHC or LITExx  
 door constructions

**CORE:**  
 75 Kpa EXPANDED POLYSTYRENE (EPA)  
 STYROFOAM CORE

NET DOOR HEIGHT



**AVAILABLE DOOR SIZES:**  
 Hardboard (without face joints) 60"x96" or 48"x120"  
 Hardboard (with face joints) 60"x144"  
 Standard Thickness - 1-3/8" or 1-3/4"

**DOOR EDGES:**  
 19mm [3/4"] min. **SOLID WOOD**  
 [SPECIES TO MATCH FACE]

**STILES:**  
 114mm [4-1/2"] SCL

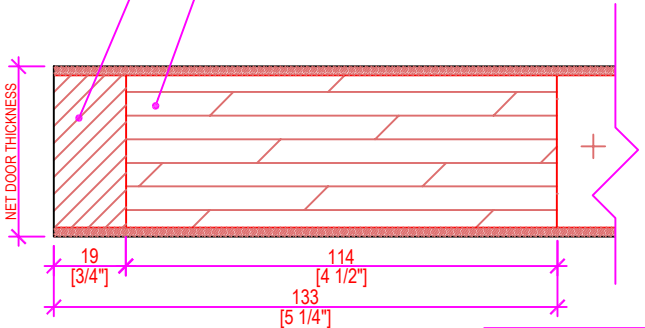

NET DOOR WIDTH

**A-A DOOR EDGE DOOR SECTION**  
 SCALE: 6" = 1'-0"

**STANDARD EDGE DETAIL**  
 #2 (AWMAC Type 'A')

|   |                       |
|---|-----------------------|
| <br><small>Manufacturers of Fine Quality Millwork Doors &amp; Paneling</small><br>1150 Sanford Street Ph: (204) 786-1411 Fax: (204) 786-2634<br>Winnipeg, MB R3E 2Z9 www.dormonddoors.com | Date:<br>MAR 10, 2021 |
|   | Revision:             |
| Drawing: LITE20-3 FOAM CORE   |                       |
| Drawn By:<br>A.D.   | Sheet:<br>1 of 1      |