

RAILS:
76mm [3"] SCL TOP & BOTTOM RAILS

AVAILABLE DOOR SIZES:
 Most Veneers (restricted by species) 54"x126"
 PL (P.Lam)(restricted by manufacturer) 60"x144"
 Standard Thickness - 1-3/8" or 1-3/4"
 Thickness Available - 1" to 2-1/2"

NET DOOR HEIGHT

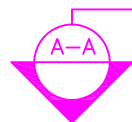

DOOR FACE:
WOOD VENEER SPECIES OR
PLASTIC LAMINATE [GP thickness] OR
ALTERNATE DOOR FINISH [as requested]

CROSSBAND:
1.6mm [1/16"] COMPOSITE HDF

CORE:
PARTICLE BOARD DOOR CORE
(ANSI A208.1 GRADE LD-1)

DOOR EDGES:
8mm [5/16"] min. SOLID WOOD
[SPECIES TO MATCH FACE]

STILES:
38mm [1-1/2"] SCL

STANDARD EDGE DETAIL
#2 (AWMAC Type 'A')
#1 (AWMAC Type 'D') AVAILABLE UPON REQUEST

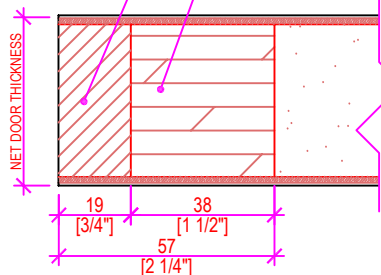

NET DOOR WIDTH

A-A DOOR EDGE DOOR SECTION
SCALE: 6" = 1'-0"

| | |
|---|-----------------------|
| <small>Manufacturers of Fine Quality Millwork Doors & Paneling</small> 1150 Sanford Street Ph: (204) 786-1411 Fax: (204) 786-2634 Winnipeg, MB R3E 2Z9 www.dormonddoors.com | Date: MAR 10, 2021 |
| | Revision: |
| Drawing: DPC-5 SOLID CORE | |
| Drawn By: A.D. | Sheet: 1 of 1 |