

45min FIRE-RATED

AVAILABLE DOOR SIZES:
Single Swing 4/0 x 10/0
***>8' Tall - Mineral Components Necessary
Minimum Thickness - 1-3/4"
Thickness Available - Up to 2-1/4"

Maximum Exposed Wired Glass size is 1296 sq. inches; not larger than 54" in any direction
Maximum Exposed Ceramic Glass is unlimited but must maintain at least 6" of door material remaining all around

RAILS:
<8' TALL: 51mm [2"] SCL TOP & BOTTOM RAILS
>8' TALL: 51mm [2"] MINERAL CORE TOP & BOTTOM RAILS c/w INTUMESCENT LAYER

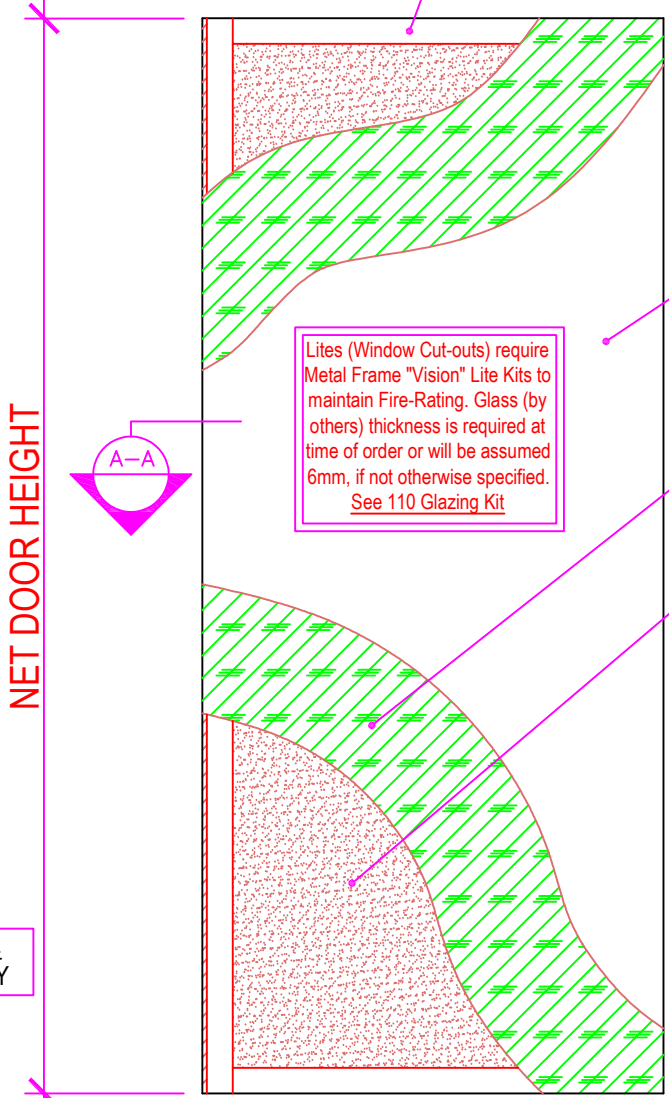

Lites (Window Cut-outs) require Metal Frame "Vision" Lite Kits to maintain Fire-Rating. Glass (by others) thickness is required at time of order or will be assumed 6mm, if not otherwise specified. See 110 Glazing Kit

DOOR FACE:
WOOD VENEER SPECIES OR PLASTIC LAMINATE [GP thickness] OR ALTERNATE DOOR FINISH [as requested]

CROSSBAND:
1.6mm [1/16"] COMPOSITE HDF

CORE:
AgriFiber APB-45
Fire Resistant Particleboard

NET DOOR HEIGHT

NET DOOR WIDTH

DOOR EDGES:
8mm [5/16"] min. SOLID WOOD [SPECIES TO MATCH FACE]

STILES:
<8' TALL: 51mm [2"] SCL
>8' TALL: 51mm [2"] MINERAL CORE

STANDARD EDGE DETAIL #2 (AWMAC Type 'A') ONLY

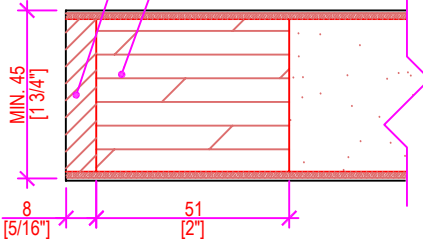

A-A DOOR EDGE DOOR SECTION
SCALE: 6" = 1'-0"

 <small>Manufacturers of Fine Quality Millwork Doors & Paneling</small> 1150 Sanford Street Ph: (204) 786-1411 Fax: (204) 786-2634 Winnipeg, MB R3E 2Z9 www.dormonddoors.com	Date: MAR 10, 2021
	Revision:
Drawing: DFD-5-45S 45min Rated	
Drawn By: A.D.	Sheet: 1 of 1