

6mm [1/4"]
HARDWOOD EDGE
TO MATCH FACE

19mm [3/4"]
MDF STILE

45min FIRE-RATED

AVAILABLE DOOR SIZES:

Pairs - Conventional 8/0 x 8/0
Pairs - Double Egress 8/0 x 8/0

Standard Thickness - 1-3/4" ONLY

Maximum Exposed Wired Glass size is 1296 sq. inches; not larger than 54" in any direction
Maximum Exposed Ceramic Glass is unlimited but must maintain at least 6" of door material remaining all around

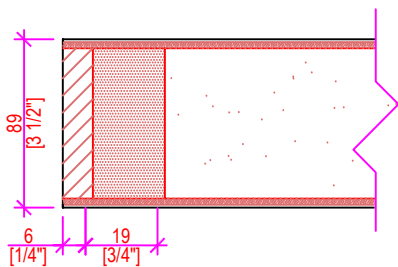

EDGE DETAIL
#2 (AWMAC Type 'A') ONLY

A-A DOOR EDGE DOOR SECTION
SCALE: 6" = 1'-0"

25mm [1"] MDF TOP & BOTTOM CAPS

NET DOOR HEIGHT

Lites (Window Cut-outs) require Metal Frame "Vision" Lite Kits to maintain Fire-Rating. Glass (by others) thickness is required at time of order or will be assumed 6mm, if not otherwise specified. See 110 Glazing Kit

DOOR FACE:
WOOD VENEER SPECIES OR
PLASTIC LAMINATE [GP thickness] OR
ALTERNATE DOOR FINISH [as requested]

CROSSBAND:
1.6mm [1/16"] COMPOSITE HDF

CORE:
Uni-Cor FR 45
Fire Resistant Particleboard

NET DOOR WIDTH

 <small>Manufacturers of Fine Quality Millwork Doors & Paneling</small> 1150 Sanford Street Ph: (204) 786-1411 Fax: (204) 786-2634 Winnipeg, MB R3E 2Z9 www.dormonddoors.com	Date: MAR 10, 2021
	Revision:
Drawing: DFD-5-45P 45min Rated	
Drawn By: A.D.	Sheet: 1 of 1