

90min FIRE-RATED

AVAILABLE DOOR SIZES:
Single Swing 4/0 x 10/0
Standard Thickness - 1-3/4"

Maximum Exposed Wired Glass
size is 100 sq. inches
Maximum Exposed Ceramic Glass
is 1296 sq. inches; not larger than
54" in any direction

STILES:
40mm [1 9/16"] ADVANCED TECHNOLOGY
90min FIRE-RATED STILE c/w INTEGRATED
8mm [5/16"] FIRE-RETARDANT TREATED
SOLID MAPLE DOOR EDGES

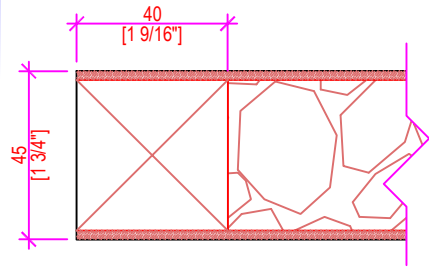

EDGE DETAIL
#2 (AWMAC Type 'A') ONLY

A-A PARTIAL PLAN SECTION
SCALE: 6" = 1'-0"

NET DOOR HEIGHT

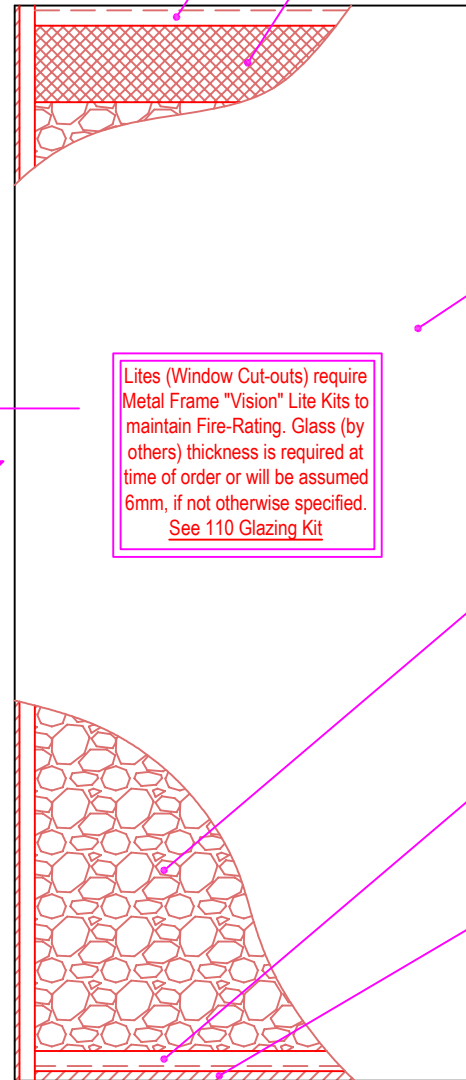
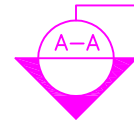

TOP RAIL:
ADVANCED TECHNOLOGY
90min FIRE-RATED COMPONENT

TOP BLOCKING:
152mm [6"] TECTONITE BLOCKING
[FOR DOOR CLOSERS]

DOOR FACE:
3mm [1/8"] HARDBOARD

Lites (Window Cut-outs) require
Metal Frame "Vision" Lite Kits to
maintain Fire-Rating. Glass (by
others) thickness is required at
time of order or will be assumed
6mm, if not otherwise specified.
See 110 Glazing Kit

CORE:
90min FIRE-RATED
MINERAL CORE

BOTTOM RAIL:
ADVANCED TECHNOLOGY
90min FIRE-RATED COMPONENT

SOLID WOOD BOTTOM CAP

NET DOOR WIDTH

DORMOND INDUSTRIES LIMITED <small>Manufacturers of Fine Quality Millwork Doors & Paneling</small> 1150 Sanford Street Ph: (204) 786-1411 Fax: (204) 786-2634 Winnipeg, MB R3E 2Z9 www.dormonddoors.com	Date: MAR 10, 2021
	Revision:
Drawing: DFD-3-90 90min Rated	
Drawn By: A.D.	Sheet: 1 of 1