

20min FIRE-RATED

AVAILABLE DOOR SIZES:

Single Swing 4/0x 9/0
Pairs - Conventional 8/0 x 9/0
Pairs - Double Egress 8/0 x 9/0

Standard Thickness - 1-3/4"

Thickness Available - Up to 2-1/4"

vDOOR EDGES:
8mm [5/16"] SOLID WOOD
[POPLAR]

STILES:
38mm [1-1/2"] SCL

STANDARD EDGE DETAIL
#2 (AWMAC Type 'A')

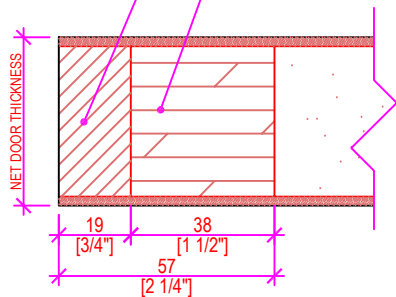

A-A DOOR EDGE DOOR SECTION
SCALE: 6" = 1'-0"

NET DOOR HEIGHT

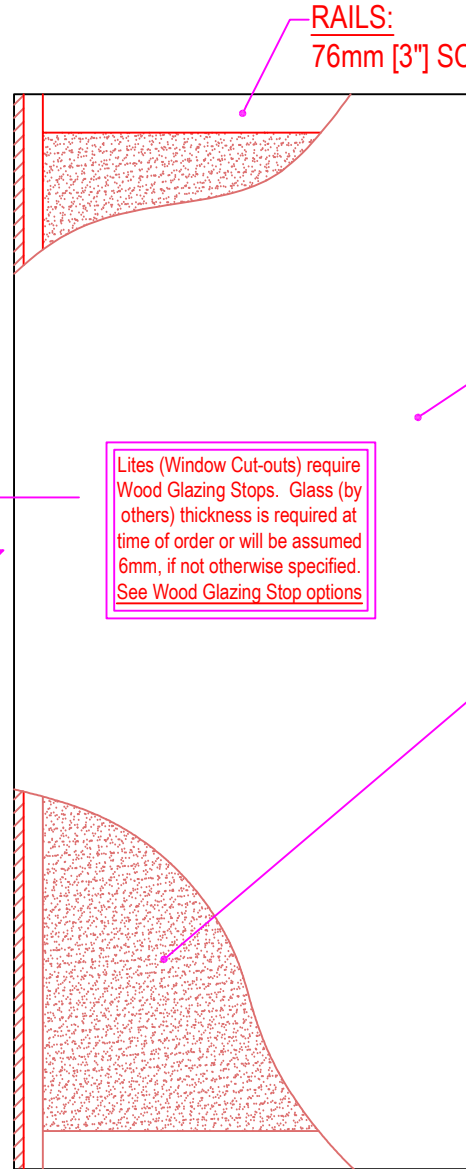
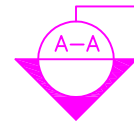

RAILS:
76mm [3"] SCL TOP & BOTTOM RAILS

DOOR FACE:
3mm [1/8"] HARDBOARD

Lites (Window Cut-outs) require
Wood Glazing Stops. Glass (by
others) thickness is required at
time of order or will be assumed
6mm, if not otherwise specified.
See Wood Glazing Stop options

CORE:
PARTICLE BOARD DOOR CORE
(ANSI A208.1 GRADE LD-1)

NET DOOR WIDTH

DORMOND INDUSTRIES LIMITED <small>Manufacturers of Fine Quality Millwork Doors & Paneling</small> 1150 Sanford Street Ph: (204) 786-1411 Fax: (204) 786-2634 Winnipeg, MB R3E 2Z9 www.dormonddoors.com	Date: MAR 30, 2021
	Revision:
Drawing: DFD-3-20 20min Rated	
Drawn By: A.D.	Sheet: 1 of 1